

Mapeflex MS Crystal Mapeflex MS 45

HYBRID SEALANTS AND ADHESIVES



Mapeflex **MS Crystal**



new

Mapeflex **MS 45**



Elastic, hybrid, crystal clear sealant and adhesive, even for damp surfaces.

USES

- Elastic sealing and bonding
- Single product for bonding and sealing
- Almost invisible seals

ADVANTAGES

- **Crystal clear:** almost invisible for a perfect finish
- **Single product** for sealing joints and bonding different materials
- **Easy** to use both indoors and outdoors
- Bonds even to **damp surfaces**
- **Odourless, solvent-free, very low emission level of VOC, no safety or hazard warning labels required**
- **Long** shelf life
- **Paintable** if required



Elastic, hybrid sealant and adhesive, even for damp surfaces.

USES

- Elastic sealing and bonding
- Single product for bonding and sealing

ADVANTAGES

- **Single product** for sealing joints and bonding different materials
- **Easy** to use both indoors and outdoors
- Bonds even to **damp surfaces**
- **Odourless, solvent-free, very low emission level of VOC, no safety or hazard warning labels required**
- **Long** shelf life
- **Paintable** if required



TRANSPARENCY 100%

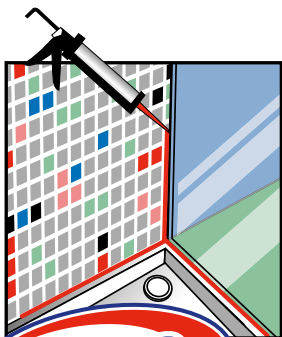

SEALS

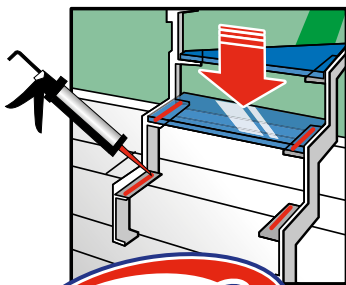

BONDS



FOR DAMP SURFACES



SEALS



BONDS



WHITE



GREY



BROWN

Due to the printing processes involved, the colours should be taken as merely indicative of the shades of the actual product.

Technical Data

Product identity

Packaging:	300 ml plastic cartridge
Colour:	crystal clear
Storage:	18 months
Dust dry:	15 minutes
Hardening:	3 mm/24 h
Shore A hardness:	35
Modulus of elasticity at 100%:	0.60 N/mm²
Paintable:	yes
Certification:	EN15651-1 (sealants for façades): F-EXT-INT EN15651-3 (sealants for façades): XS1 ISO11600 (mechanical performance): F 20 HM
Primer:	Primer FD on absorbent or compact substrates for severe service conditions Primer P for many types of elastic substrates



Technical Data

Product identity

Packaging:	300 ml plastic cartridge
Colour:	white, 113 grey, brown
Storage:	15 months
Dust dry:	30 minutes
Hardening:	3 mm/24 h
Shore A hardness:	36
Modulus of elasticity at 100%:	0.75 N/mm²
Paintable:	yes
Certification:	EN15651-1 (sealants for façades): F-EXT-INT EN15651-4 (sealants for flooring): PW-EX-INT-CC ISO11600 (mechanical performance): F 20 HM
Primer:	Primer FD on absorbent or compact substrates for severe service conditions Primer P for many types of elastic substrates





● **Technical documentation**

From the technical area menu you can view the technical documentation divided per product lines and type of document.

HEAD OFFICE
MAPEI S.p.A.
Via Cafiero, 22 - 20158 Milan
Tel. +39-02-37673.1
Fax +39-02-37673.214
Internet: www.mapei.com
E-mail: mapei@mapei.it

